

033358

RECEIVED
LARAMIE COUNTY
CHEYENNE, WY.

'87 AUG 28 AM 9 09

CERTIFIED LAND CORNER RECORDATION

DESCRIPTION OF CORNER EVIDENCE FOUND, AND ORIGINAL RECORD (if known)

T. 14 N.
1/4 20 | 21
R. 70 W.

FOUND: STANDARD C.L.O. MONUMENT, 1" IRON PIPE WITH 2 1/2" BRASS CAP PROJECTING 0.3 FEET ABOVE GROUND WITH A COLLAR OF STONE AND STAMPED AS SHOWN BELOW.

DESCRIPTION OF MONUMENT AND ACCESSORIES ESTABLISHED TO PERPETUATE THE ORIGINAL LOCATION OF THIS CORNER:

SEE TIES BELOW

SKETCH, WITH COURSE AND DISTANCE TO ADJACENT CORNER IF DETERMINED IN THIS SURVEY. (May Sketch or Paste Reproduction on Reverse Side.)

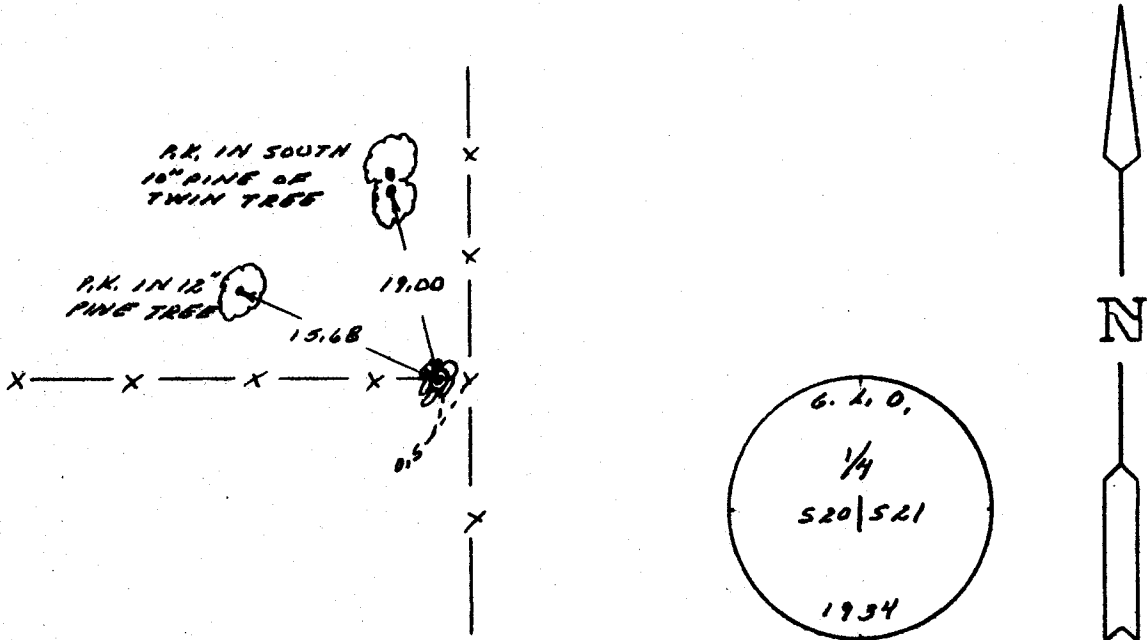

I, JOHN A. STELL certify that I have carefully performed or reviewed the work done on the diagrammed corner as reported on this recordation form and approve the same.

John A. Stell
Signature of Surveyor

45,250
Registration No.

STATE OF WYOMING,
Office of Clerk and Recorder,
County of Laramie

This "corner record" was filed for record on the 28 day of August, 1987, was noted on the cross-index plat and is assigned page No. _____, in book No. _____

Jack C. Whitcomb
County Official

Cross Index No. <u>P-9</u>	T. <u>14N</u>	R. <u>70W</u>	Mer. <u>6th</u>
_____	T. _____	R. _____	Mer. _____
_____	T. _____	R. _____	Mer. _____
_____	T. _____	R. _____	Mer. _____
_____	T. _____	R. _____	Mer. _____
_____	T. _____	R. _____	Mer. _____
_____	T. _____	R. _____	Mer. _____